

# PAXTON HOUSE

39-41 Chestnut Grove, Borrowwash, Derbyshire



**Paxton House is a residential service in Borrowwash for young adults with learning disabilities and/or autism and complex needs.**

- Accommodation for up to eight people
- Situated in a quiet residential area
- 6 large bedrooms, all with en-suite shower rooms
- 2 rooms with additional living space and kitchen facilities to promote and support pathways to more independent living.
- Adaptions to the property can be made to ensure the needs and choices of individuals are met
- Facilitated by an experienced and positive staff team

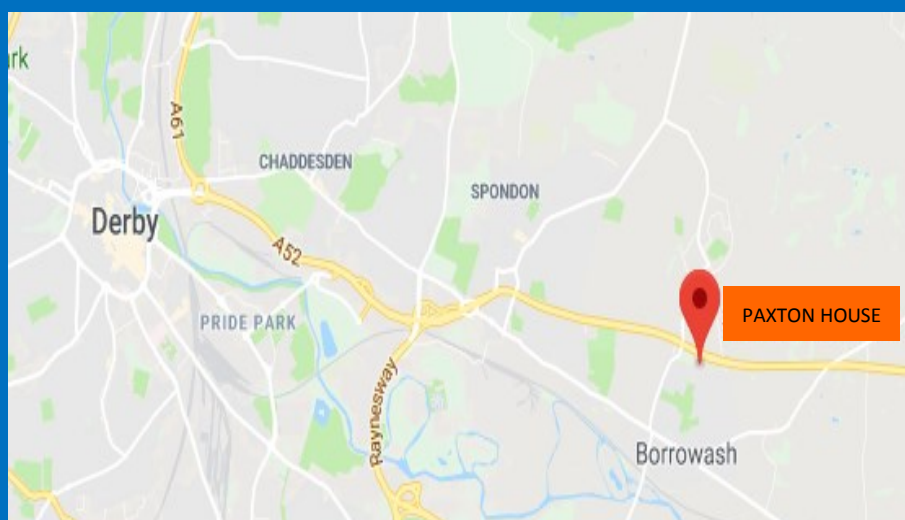

The service is situated in a quiet residential area of the village; close to local facilities such as shops and parks and on a bus route that provides good links directly into both Derby and Nottingham whilst being only a 10 minute drive to the M1.



Paxton House offers people with high support needs an individualised package of support in a positive and stable environment - aiming to build confidence, develop daily living, promote community inclusion in line with personalised outcomes.

**“Paxton House is an excellent home providing great support and great choices”**

**“I am very impressed with the service, it’s consistently demonstrates the correct values and approach to the service users living there”**

*Health & Social Work Professionals*

The services provides accommodation for up to eight people - including six large bedrooms, all with en-suite shower rooms.

In addition there are kitchen facilities and an en-suite shower room to promote and support more independent living.

The house is modern and spacious, with a variety of communal areas including a lounge diner, Kitchen diner, conservatory, two separate lounges – one with kitchen facilities, large garden and enclosed rear patio.

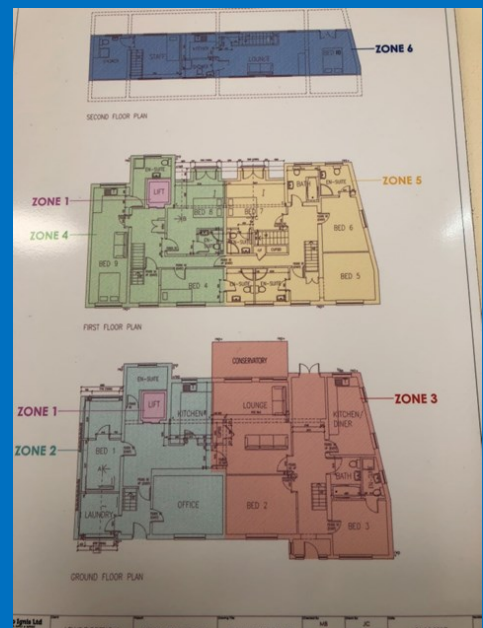

**For further information or talk through referrals contact:**

**Donna Briggs - Registered Service Manager**

**TEL: 01332667848 or 07384631309**

**Email: Donna.briggs@potens-uk.com**

**Dave Ridley - Potens Area Manager**

**TEL: 07886884250**

**Email: Dave.ridley@potens-uk.com**

**[www.potens-uk.com](http://www.potens-uk.com)**